

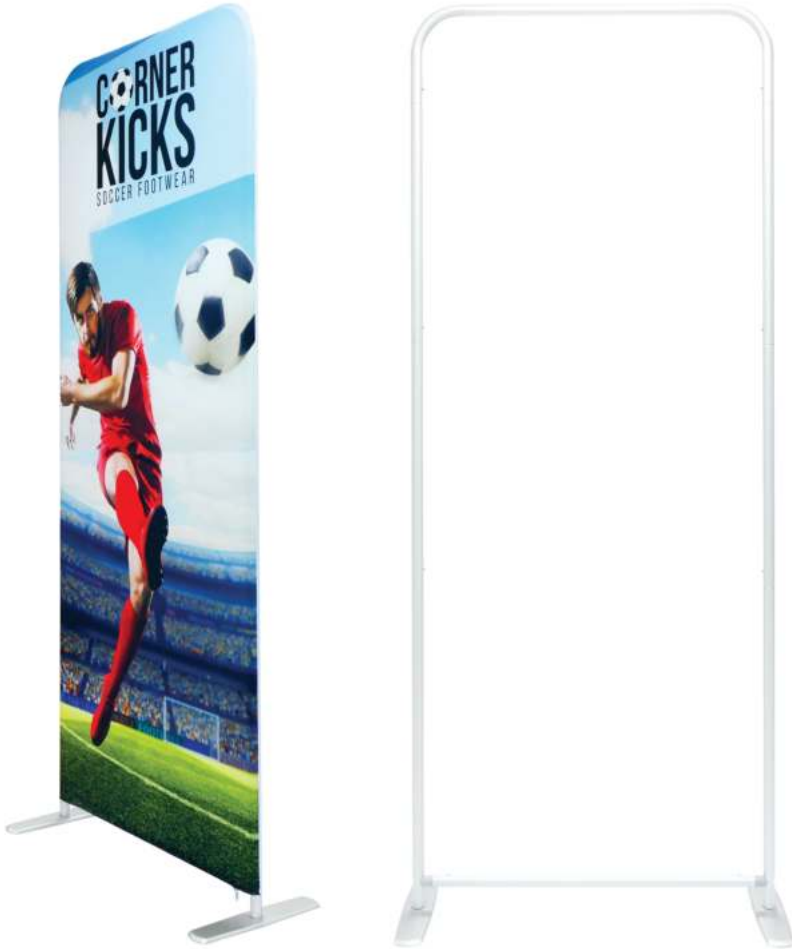

On frame On graphic



PRODUCT DESCRIPTION

With a sleek and thinner diameter, our new EZ Stand frames are a great alternative to our premium backwall displays. Quickly assembled in just minutes, slide the tubes together and lock them in place with a push button snap to assemble the frame. Then, simply pull the pillowcase-like graphic over the frame and zip it shut. The bottom zipper - hidden from view, tightens the stretch fabric beautifully displaying your graphic from edge to edge. Disassembled, the lightweight frame and graphic fits inside a beautiful compact silver bag. Like our premium EZ Tube, the EZ Stand is also available in several sizes and shapes. Quantity pricing is available on our website.

DISPLAY DIMENSIONS	37.5"W x 90"H x 15.75"D
GRAPHIC SIZE	38"W x 90"H

GRAPHIC MATERIAL

Stretch Fabric

GRAPHIC FINISHING

Sewn on top, left, and right. Zipper on bottom.

DISPLAY CONSTRUCTION

Aluminum frame (30mm tubing) and feet (allen key included)

SHIPPING WEIGHTS & DIMENSIONS

Shipping Weight	5 lbs (frame only) 9 lbs (frame and graphic)
Shipping Dimensions	39"L x 11"W x 4"H

LARGE QUANTITY FREIGHT

Freight Shipping	25 boxes per 48"L x 40"W x 29"H skid
Freight Weight	170 lbs (frame only) 270 lbs (frame and graphic)

GRAPHIC TURN AROUND TIME

2 business days after proof approval

AVAILABLE ACCESSORIES

Silver/Black LED Lights	Silver Bag
AVAILABILITY	
CA and PA	



Silver bag (Optional)



Flat feet (3.125"W x 15.75"L)



LED Light - Silver (Optional)



LED Light - Black (Optional)

PARTS LIST



Qty.1 - 36" Top Tubing



Qty.4 - 24" Vertical Tubing

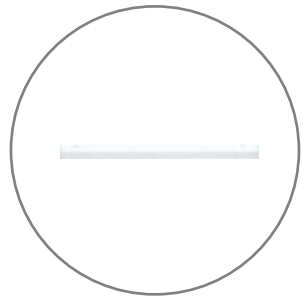

Qty. 1 - Bottom Tubing

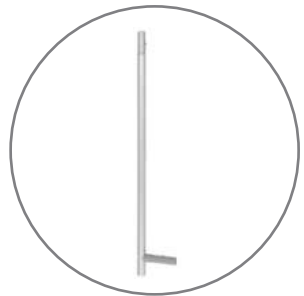

Qty.2 - 32" Vertical Tubing



Qty. 2 - Bolts
(Allen key included)



Qty.2 - Base/Foot

SET UP INSTRUCTIONS

2FT



24"x90"

3FT

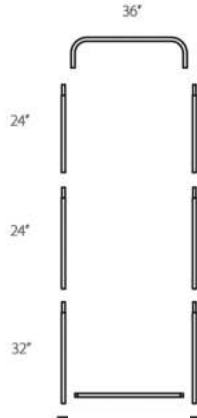

36"x90"

4FT

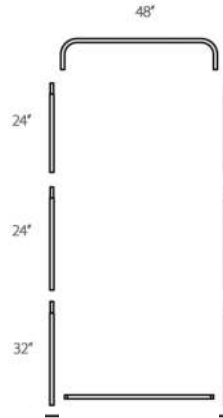

48"x90"

5FT

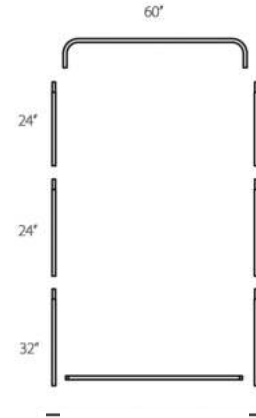

60"x90"

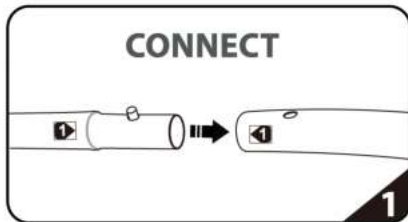

Connect numbered tubes together.

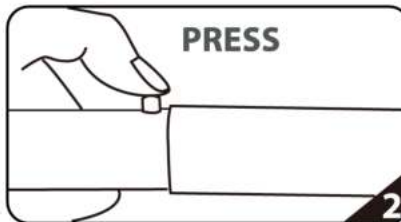

Snap tubes together.

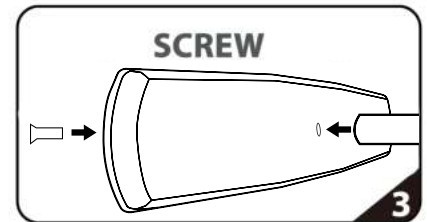

Screw foot to tube with threaded bottom.

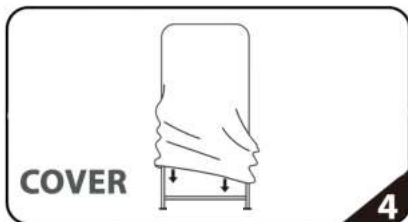

Cover frame with fabric graphic.

To assemble, secure the longest vertical poles onto the pair of feet using the included allen wrench. Add the bottom horizontal support pole and secure. Snap on the remaining vertical poles, then top frame with the curved bar to complete. Tilt or lay down **EZSTAND** to swiftly drape with the pillowcase graphic. Using the industrial-sized zipper, zip underneath the bottom support pole, maximizing fabric tension.

